

Commercial Roofing

Modified Bitumen	3
Tamko Roofing	3
GAF Roofing	3
EPDM Membrane & Accessories	3
Firestone EPDM Roofing System	3
GenFlex Roofing	4
TPO Membrane & Accessories	4
Genflex TPO	5
Firestone TPO Roofing System	6
Built Up Roofing Roll Products	6
Firestone Roofing Systems	6
GAF Roofing	6
Tamko Roofing	6
Roof Insulation & Tapered Systems	10
Atlas Roofing	10
Stucco Shield	10
Polyiso Insulation	10
Tapered Polyiso Insulation	13
Polystyrene Insulation	15
Fasteners	15
Atlas Roofing	15
GenFlex Roofing	15
Roofing Asphalt	15
Owens Corning	15
Gypsum Wallboard	17
Georgia Pacific	17
Roof Pavers	18
Westile Roofing	18
Built Up Roofing Equipment	18
Louisville Ladder	18
Stepladder	19
Twin Front Ladder	22
Platform Ladders	24
Extension Ladders	25

Cleasby Roofing	29
Lo - Loader Kettles	29
Oil Jacketed Kettles	31
Kettle Pumps	31
Kettle Accessories	32
Mops & Hand Tools	33
Skylights & Roof Hatches	33
American Skylites	34
Bilco	34
Roof Scuttles	34
Milcor	34
Reglet	34
Fry Reglet	34

Modified Bitumen > Tamko Roofing

Tamko Roofing

Modified Bitumen > GAF Roofing

GAF Roofing

EPDM Membrane & Accessories > Firestone EPDM Roofing System

Firestone EPDM Roofing System

EPDM Roofing Systems

Durability, design versatility and installation ease are among the many reasons ethylene propylene diene monomer (EPDM) is the most popular material for both new and reroof low-slope roofing applications.

Firestone's single-ply EPDM roofing systems are based on a high-performance synthetic rubber compound that provides outstanding weathering characteristics in climates worldwide. From office buildings and distribution warehouses to hospitals and schools, Firestone has an EPDM roofing solution that's right for you.



- **Firestone RubberGard EPDM**
- **Firestone RubberGard Platinum EPDM**
- **Firestone RubberGard EcoWhite EPDM**
- **Firestone RubberGard R.M.A.**

EPDM Membrane & Accessories > GenFlex Roofing

GenFlex Roofing

GenFlex Roofing Systems features three single-ply EPDM membranes: GenFlex EPDM (Ethylene Propylene Diene Monomer) - an elastomeric membrane GenFlex AFR # an EPDM membrane that is fire retardant, and GenFlex FRM - an EPDM membrane reinforced with tough polyester fabric. Both are designed for ultra high performance. GenFlex EPDM systems have a performance history of over 20 years and can be warranted for up to 20 years depending on the system design.

EPDM comes 45 mil (1.1mm) or 60 mil (1.5mm) thick and is available in rolls up to 50'(15.2m) wide by 250' (76.2m) long. It is ideal for either new roofs or for roofing over a variety of common roof deck types and insulation materials.

Installation systems include ballasted, fully-adhered and a number of mechanically-attached alternatives. Components include roofing tapes, bonding adhesive, sealants, flashing and applicable rooftop accessories.

This is a high-performance membrane, resistant to tears, impacts, punctures and normal roof traffic. Normal structural movement has limited effect on its integrity. This membrane provides excellent resistance to ozone and ultraviolet light exposure.

AFR Membrane is standard EPDM that is designed to be fire retardant for low slope roofs on a variety of deck types.

GenFlex EPDM AFR membrane may be installed as a fully adhered, mechanically attached, or ballasted system. Available in 45 mil (1.1mm) and 60 mil (1.5mm) thick, 10# (3.1m), 16.63# (5.2m), and 20# (6.1m) wide by 50# (15.3m) or 100# (30.5m) long.

FRM membrane has most of the same characteristics of the EPDM membrane. In fact, the FRM is standard EPDM reinforced with a tough polyester fabric. The result is superior fatigue, tear and puncture resistance. Installs using the Bar in Seam or Fully Adhered System.

Available 45 mil (1.1mm) or 60 mil (1.5mm) thick, 10'(3.0m) wide by 100'(30.5m) long.

All three membranes are designed for those situations that demand superior tensile strength performance. It Fast, tough, long-lasting.



TPO Membrane & Accessories > Genflex TPO

Genflex TPO

GenFlex TPO membrane was introduced in 1996 and is manufactured at our state-of-the-art extrusion technology facility in Muscle Shoals, Alabama, where we have produced the industry's first 12-foot wide sheet meeting industry code requirements.

The 12-foot wide sheet offers significant benefits including fewer seams to weld and fewer panels to install. With fewer seams and fewer panels for most applications, there is a significant cost advantage to a 12-foot fully adhered system. Compared to a 10-foot system, the wide sheet application requires 16% fewer seams, 33% fewer than an 8-foot system, and 50% fewer than a 6-foot system.

GenFlex TPO membrane, a high quality thermoplastic polyolefin, offers the best of both worlds...the proven flexibility and weathering resistance of rubber and the performance of hot-air welded thermoplastic seams. GenFlex TPO membrane meets all the requirements of the new TPO ASTM Standard D 6878-03.

Heat-welded thermoplastic roofing membranes are the fastest growing segment of the low-slope roofing market and GenFlex TPO is an excellent system choice. GenFlex TPO roofing systems are designed for durability and to withstand extreme environmental exposure. GenFlex TPO systems offer the widest selection in both product and system types. From dual weld seams to Peel & Stick systems, GenFlex has the TPO products you need for mechanically anchored to fully adhered systems with warranties up to 20 years depending on the system design.



GenFlex TPO membranes are produced with a minimum top ply film thickness of 15 mils over scrim. This top ply has outstanding weathering and welding characteristics in addition to a smooth finish designed to resist dirt accumulation for long-term aesthetics.

Introduced in 2003, the GenFlex Peel & Stick™ TPO Membrane System is truly a revolutionary new era in roofing. Peel & Stick TPO membranes and accessories have pre-applied adhesive and tape, making installation faster, easier, safer and smarter. Now available in a 10-foot roll as well.

No application of bonding adhesive means little or no solvent fumes for crews and no exposure to building occupants during installation. This new Peel & Stick technology can also eliminate the need for generators and walker welders which also add up to greater economy and efficiency.

The GenFlex Peel & Stick Membrane System cuts membrane installation time and significantly reduces labor. The UL and FM code rated membrane is simply aligned on the approved substrate, then the release liner is removed and the membrane is broomed down with positive pressure to ensure adhesion. It's that simple. TPO accessories, pipe boots, seam tape and TPO cover tape all go down quick, clean and easy with GenFlex Peel & Stick technology.

TPO Membrane & Accessories > Firestone TPO Roofing System**Firestone TPO Roofing System**

TPO Roofing Systems

Thermoplastic single-ply roofing membranes are among the fastest growing commercial roofing products and have gained broad industry acceptance for their many performance and installation advantages. As demand increases for heat-reflective and energy efficient roofing systems, thermoplastic polyolefin (TPO) single-ply roofing membranes continue to provide exceptional resistance to ultraviolet, ozone and chemical exposure.

- **Firestone UltraPly TPO**
- **Firestone Platinum TPO**
- **Firestone ReflexEON TPO**
- **Firestone UltraPly TPO XR**

**Built Up Roofing Roll Products > Firestone Roofing Systems****Firestone Roofing Systems**

Asphalt Roofing Systems

Whether your design solution calls for a pre-manufactured Modified Bitumen membrane system, a standard built-up system, or a hybrid Built-Up Roofing/Modified Bitumen system, Firestone is uniquely positioned to meet your asphalt roofing system requirements. Firestone manufactures a diverse product line of base sheets, ply sheets, and cap sheets along with installation tools to give you a single source for quality asphalt-based roofing materials.

- **Firestone SBS**
- **Firestone APP**
- **Firestone BUR**
- **Firestone Self-Adhered Base**

**Built Up Roofing Roll Products > GAF Roofing****GAF Roofing****Built Up Roofing Roll Products > Tamko Roofing****AWAPLAN PREMIUM FR**

Fire resistant SBS-modified asphalt roll roofing, granule-surfaced

Consists of a 250 g/m² polyester mat saturated with asphalt and coated with patented fire-resistant SBS-modified asphalt. It is available in mop grade and exhibits tremendous elasticity and strength with superior resistance to thermal shock and punctures. Awaplan Premium FR is suitable for flashing as well as field roofing.

Application method: Hot asphalt.





AWAPLAN PREMIUM

Top-of-the-line Awaplan Premium products feature a 250 g/m² polyester mat saturated with asphalt and coated with SBS-modified asphalt. Awaplan Premium exhibits tremendous elasticity and strength with superior resistance to thermal shock and punctures. Suitable for flashing as well as field roofing, this premium series includes hot-asphalt and cold-applied application options.

Application method: Hot asphalt or approved cold adhesive.

AWAPLAN VERSAFLEX

AWAPLAN VERSAFLEX is reinforced with a 180 g/m² nonwoven polyester mat saturated with asphalt and coated on both sides with SBS-rubber-modified asphalt.

Base ply in 2-ply modified systems, modified membrane in Series 1300 Specifications.



VERSA-CAP FR

VERSA-CAP FR consists of a TAMKO fiberglass mat coated on both sides with fire-resistant SBS-rubber-modified asphalt, and surfaced with ceramic granules for protection from ultraviolet degradation.

Roofing membrane in Series 700 Specifications.

AWAFLEX

AWAFLEX is reinforced with a 155 g/m² nonwoven polyester mat saturated with asphalt and coated on both sides with SBS-rubber-modified asphalt, and surfaced with ceramic granules for protection from ultraviolet degradation.

Roofing membrane in Series 1000 Specifications and flashing membrane in select TAMKO flashing details.



AWAFLEX FR

AWAFLEX FR is reinforced with a 155 g/m² nonwoven polyester mat saturated with asphalt and coated on both sides with fire-resistant SBS-rubber-modified asphalt, and surfaced with ceramic granules for protection from ultraviolet degradation.

Roofing membrane in Series 1000FR Specifications and flashing membrane in select TAMKO flashing details.

AWAPLAN VERSA-SMOOTH

Awaplan Versa-Smooth is part of the TAMKO Awaplan line of SBS-modified products and is designed for applications that demand superior performance. Designed to providing outstanding tensile strength, elasticity, fatigue resistance, puncture resistance, crack-bridging capacity, and low-temperature flexibility, Awaplan Versa-Smooth can be specified for hot-mopping, heat-welding, cold-process-adhesive applications, or by mechanically fastening.

AWAPLAN VERSA-SMOOTH is reinforced with a 180 g/m2 nonwoven polyester mat saturated with asphalt and coated on both sides with SBS-rubber-modified asphalt.

Base ply in 2-ply modified systems, modified membrane in Specifications 243 and 244, and flashing membrane in select TAMKO flashing details with approved coating.



AWAPLAN HEAT WELDING

Awaplan heat Welding is a premium grade product which features a 250g/m2 polyester mat saturated with asphalt and coated with SBS-modified asphalt. Awaplan Premium and Awaplan Heat Welding exhibit tremendous elasticity and strength with superior resistance to thermal shock and punctures. Suitable for flashing as well as field roofing, this premium product includes hot-asphalt, heat-weld, and cold-applied application options.

Application method: Torch applied, hot asphalt, cold-applied.



AWAPLAN 170

AWAPLAN 170 is reinforced with a 180 g/m2 nonwoven polyester mat saturated with asphalt and coated on both sides with SBS-rubber-modified asphalt, and surfaced with ceramic granules for protection from ultraviolet degradation.

Roofing membrane in Series 200 Specifications and flashing membrane in select TAMKO flashing details.



AWAPLAN 170 FR

AWAPLAN 170 FR is reinforced with a 180 g/m2 nonwoven polyester mat saturated with asphalt and coated on both sides with fire-resistant SBS-rubber-modified asphalt, and surfaced with ceramic granules for protection from ultraviolet degradation.

Roofing membrane in Series 200FR Specifications and flashing membrane in select TAMKO flashing details.



TAMKO APP S

TAMKO APP S is a smooth surface membrane, reinforced with a 180 g/m2 non-woven polyester mat saturated with asphalt and coated on both sides with APP-modified asphalt, and finished with a waffle back burn-off film.

Roofing membrane is Series 1200 Specifications.





TAMKO APP G

TAMKO APP G is reinforced with a 180 g/m² non-woven polyester mat saturated with asphalt and coated on both sides with APP-modified asphalt, surfaced with ceramic granules for protection from ultraviolet degradation and finished with a waffle back burn-off film.

Roofing membrane is Series 1100 Specifications, flashing membrane in all TAMKO APP flashing details.

TAM - PLY IV

TAM -PLY IV is a high-performance fiberglass ply sheet constructed with a TAMKO fiberglass mat coated with weathering-grade asphalt. It has product and system tensile strength exceeding current ASTM and NBS recommendations.

Base ply or reinforcing ply sheet for select modified roofing system specifications and reinforcing ply sheet in Series 600 Specifications.



VAPOR-CHAN

VAPOR-CHAN is a heavyweight venting base sheet constructed with a TAMKO fiberglass mat coated with weathering-grade asphalt. The bottom surface is embedded with mineral granules and embossed with a brick/stone pattern.

To relieve vapor pressure over lightweight insulating concrete or gypsum decks. It is also specified in modified roofing systems installed over existing roofing systems.

GLASS-BASE

GLASS-BASE is a fiberglass base sheet constructed with a heavyweight TAMKO fiberglass mat coated with weathering-grade asphalt.

Base sheet in select TAMKO modified asphalt and fiberglass roofing systems and as an alternate for TAMKO TYPE 43 Coated Base Sheet in any TAMKO specification.



TAM-GLASS PREMIUM

TAM-GLASS PREMIUM is a high-performance fiberglass ply sheet constructed with a TAMKO heavyweight fiberglass mat coated with weathering-grade asphalt. It demonstrates excellent isotropic tensile strength. System tensile strength is far greater than current NBS performance criteria.

Base ply or reinforcing ply sheet for select modified roofing system specifications and reinforcing ply sheet in Series 500 Specifications.

BASE-N-PLY

BASE-N-PLY consists of a TAMKO fiberglass mat coated on both sides with asphalt that has been lightly modified with SBS rubber.

Base ply in select Series 100, 200, and 700 Specifications and as an alternate for TAMKO GLASS-BASE or TYPE 43 Coated Base Sheet in any TAMKO specification.





VERSA-BASE

VERSA-BASE consists of a TAMKO fiberglass mat coated on both sides with SBS-rubber-modified asphalt.

Base ply in select Series 100, 200, and 700 Specifications and as an alternate for TAMKO GLASS-BASE or TYPE 43 Coated Base Sheet in any TAMKO specification. It also serves as a good vapor retarder when set in hot asphalt or between layers of insulation.

Roof Insulation & Tapered Systems > Atlas Roofing > Stucco Shield

Stucco-Shield

Stucco-Shield Sheathing features ACUltra Technology which means ZERO HCFC's - a cost effective "Green" building solution. Excellent R-Values reduce energy demands while meeting or exceeding the Model Energy Code for your area, and also greatly reducing the potential for condensation problems.

Stucco-Shield is a rigid, polyiso foam board with specially coated, patented facers on both surfaces specifically for use as substrate for polymer type and hard coat stucco systems.

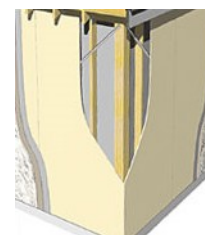

Roof Insulation & Tapered Systems > Atlas Roofing > Polyiso Insulation

ACFoam Nail Base

ACFoam Nail Base Insulation is a thermally efficient polyiso insulation board bonded to 7/16" APA/TECO rated OSB on the top side and with a glass fiber reinforced felt facer on the bottom. ACFoam Nail Base Insulation provides the desirable benefits of both a nailable surface and insulation making installation an easy one-step labor saving process. This product is made to order in 4' x 8' (1220mm x 2440mm) panels and in nominal thicknesses of 1.5" to 4.5". Other thicknesses are available on special order.



ACFoam CrossVent RB

ACFoam CrossVent RB improves the thermal efficiency of standard CrossVent by including a radiant barrier on the underside of the OSB nailing surface. It consists of a polyiso insulation board with 1.0", 1.5" or 2.0" vent spacer strips separating 7/16" APA/TECO rated radiant barrier OSB from the polyiso foam insulation to create a cross-ventilating air space. The radiant barrier diminishes heat transfer, and the spacer strips allow air to flow through the air space, thereby reducing radiant heat transfer, helping to further dissipate heat build-up beneath the OSB. CrossVent RB is made to order in 4' x 8' (1220mm x 2440mm) size panels and in normal thickness of 2.5" to 6.5". Non-standard vent spaces are available on special order.

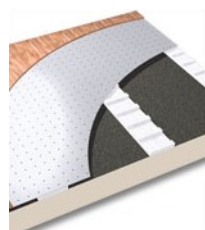

ACFoam CrossVent RB

ACFoam CrossVent RB improves the thermal efficiency of standard CrossVent by including a radiant barrier on the underside of the OSB nailing surface. It consists of a polyiso insulation board with 1.0", 1.5" or 2.0" vent spacer strips separating 7/16" APA/TECO rated radiant barrier OSB from the polyiso foam insulation to create a cross-ventilating air space. The radiant barrier diminishes heat transfer, and the spacer strips allow air to flow through the air space, thereby reducing radiant heat transfer, helping to further dissipate heat build-up beneath the OSB. CrossVent RB is made to order in 4' x 8' (1220mm x 2440mm) size panels and in normal thickness of 2.5" to 6.5". Non-standard vent spaces are available on special order.

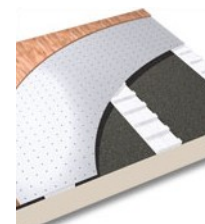



ACFoam CrossVent

Patented ACFoam CrossVent insulation consists of a thermally efficient polyiso insulation board with 1.0", 1.5" or 2.0" vent spacer strips separating 7/16 in. APA/TECO rated OSB from the polyiso foam insulation to create a cross ventilating airspace. CrossVent combines the desirable benefits of a nailable surface and insulation with the addition of a cross ventilating airspace. CrossVent is made to order in 4' x 8' (1220mm x 2440mm) size panels and in nominal thicknesses of 2.5" to 6.5". Non-Standard vent spaces are available on special order.

ACFoam Supreme

ACFoam Supreme features ACUltra Technology which means ZERO HCFC's - a cost effective "Green" building solution. Excellent R-Values reduce energy demands while maintaining compatibility with all types of roofing membranes and fire assemblies. ACFoam Supreme features closed-cell polyiso with tri-laminate foil facers. Available in 4' x 4' (1220mm x 1220mm) and 4' x 8' (1220mm x 2440mm) panels.

In 1998, years ahead of the Environmental Protection Agency timetable for eliminating HCFCs (hydrochlorofluorocarbons), Atlas introduced a line of ACFoam Products that are environmentally sensitive and available for virtually every type of construction system. Through a patented hydrocarbon blowing technology called ACUltra, Atlas began the phaseout of HCFCs in the manufacturing of foam insulation and anticipates the complete removal of HCFCs from all Atlas foam products within the next year.



ACFoam Composite/GB

ACFoam Composite/GB features Atlas closed-cell polyiso foam bonded to 1/4" or 1/2" primed glass-mat gypsum board on the top and a fiber-reinforced felt facer on the bottom. The glass-mat gypsum board provides a dense protection layer for the primary foam insulation and has a 500-psi compressive strength, which makes Composite/GB a good choice where foot traffic is a concern. Available in 4' x 4' (1220mm x 1220mm) panels.

In 1998, years ahead of the Environmental Protection Agency timetable for eliminating HCFCs (hydrochlorofluorocarbons), Atlas introduced a line of ACFoam Products that are environmentally sensitive and available for virtually every type of construction system. Through a patented hydrocarbon blowing technology called ACUltra, Atlas began the phaseout of HCFCs in the manufacturing of foam insulation and anticipates the complete removal of HCFCs from all Atlas foam products within the next year.

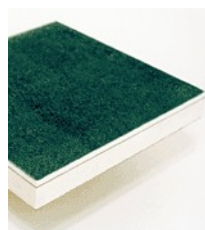

ACFoam Composite/FB

ACFoam Composite/FB consists of Atlas closed-cell polyiso bonded to 1#2" high density wood fiberboard on the top and a fiber-reinforced felt facer on the bottom. The wood fiberboard top eliminates the need for cover boards or vented base sheets normally recommended over foam insulations. ACFoam Composite/FB may be used with BUR, modified bitumen, and single-ply systems. Consult membrane manufacturer for system details. Available in 4' x 4' (1220mm x 1220mm) and 4' x 8' (1220mm x 2440mm) panels.

In 1998, years ahead of the Environmental Protection Agency timetable for eliminating HCFCs (hydrochlorofluorocarbons), Atlas introduced a line of ACFoam Products that are environmentally sensitive and available for virtually every type of construction system. Through a patented hydrocarbon blowing technology called ACUltra, Atlas began the phaseout of HCFCs in the manufacturing of foam insulation and anticipates the complete removal of HCFCs from all Atlas foam products within the next year.



ACFoam Recover Board

ACFoam Recover Board features ACUltra Technology which means ZERO HCFC's - a cost effective "Green" building solution. Excellent R-Values reduce energy demands while maintaining compatibility with all types of roofing membranes and fire assemblies. ACFoam Recover Board is part of the Atlas family of thermally efficient, polyiso foam board insulations. The foam core of Recover Board is covered on both sides with heavy coated-glass facers. Available in 4' x 4' (1220mm x 1220mm) and 4' x 8' (1220mm x 2440mm) panels.



In 1998, years ahead of the Environmental Protection Agency timetable for eliminating HCFCs (hydrochlorofluorocarbons), Atlas introduced a line of ACFoam Products that are environmentally sensitive and available for virtually every type of construction system. Through a patented hydrocarbon blowing technology called ACUltra, Atlas began the phaseout of HCFCs in the manufacturing of foam insulation and anticipates the complete removal of HCFCs from all Atlas foam products within the next year.

ACFoam III

ACFoam III features ACUltra Technology which means ZERO HCFC's - a cost effective "Green" building solution. Excellent R-Values reduce energy demands while maintaining compatibility with all types of roofing membranes and fire assemblies. ACFoam-III is a closed-cell, polyiso foam core integrally laminated to heavy coated-glass facers. ACFoam-III is also available in 25-psi formula. Available in 4' x 4' (1220mm x 1220mm) and 4' x 8' (1220mm x 2440mm) panels.



In 1998, years ahead of the Environmental Protection Agency timetable for eliminating HCFCs (hydrochlorofluorocarbons), Atlas introduced a line of ACFoam Products that are environmentally sensitive and available for virtually every type of construction system. Through a patented hydrocarbon blowing technology called ACUltra, Atlas began the phaseout of HCFCs in the manufacturing of foam insulation and anticipates the complete removal of HCFCs from all Atlas foam products within the next year.

ACFoam II

ACFoam II features ACUltra Technology which means ZERO HCFC's - a cost effective "Green" building solution. Excellent R-Values reduce energy demands while maintaining compatibility with all types of roofing membranes and fire assemblies. ACFoam-II is offered in a variety of thicknesses, providing long-term thermal resistance (LTTR) values from 6.0 to 25.0. ACFoam-II is a closed-cell, polyiso core integrally laminated to heavy black (non-asphaltic), fiber-reinforced felt facers. ACFoam-II is also available in 25-psi formula. Available in 4' x 4' (1220mm x 1220mm) and 4' x 8' (1220mm x 2440mm) panels.



In 1998, years ahead of the Environmental Protection Agency timetable for eliminating HCFCs (hydrochlorofluorocarbons), Atlas introduced a line of ACFoam Products that are environmentally sensitive and available for virtually every type of construction system. Through a patented hydrocarbon blowing technology called ACUltra, Atlas began the phaseout of HCFCs in the manufacturing of foam insulation and anticipates the complete removal of HCFCs from all Atlas foam products within the next year.

Roof Insulation & Tapered Systems > Atlas Roofing > Tapered Polyiso Insulation

GEMINI DRAIN SETS

PRE-MANUFACTURED ONE-PIECE GEMINI DRAIN SETS ARE AN ESSENTIAL FEATURE OF A WELL-DESIGNED ROOF SYSTEM

Even with the use of tapered insulation and the use of crickets, many roof designs still don't eliminate ponding around the drain area. Hand cut drain sumps are even worse because contractors often cut off facers, resulting in membrane adhesion problems, or uneven slopes to the drain which could cause ponding.

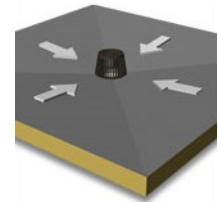

Atlas has developed the perfect solution with this one-piece 4# x 4# sloped polyiso drain set. Available with either a 1.5" or 3.0" maximum thickness. Gemini Drain Sets install quickly, save labor costs and eliminate rooftop waste. And Atlas Gemini Drain Sets are designed to mate perfectly with Atlas tapered insulation panels and Gemini Crickets.

Tapered ACFoam Composite/GB

Tapered ACFoam Composite/GB consists of Atlas closed-cell polyiso foam bonded to 1/4" or 1/2" primed glassmat gypsum board on the top and a fiber-reinforced felt facer on the bottom. It is manufactured in a tapered profile to attain positive drainage. The glass-mat gypsum board provides a dense protection layer for the primary foam insulation and has a 500-psi compressive strength, which makes Composite/GB a good choice where foot traffic is a concern. Available in 4' x 4' (1220mm x 1220mm) only.



In 1998, years ahead of the Environmental Protection Agency timetable for eliminating HCFCs (hydrochlorofluorocarbons), Atlas introduced a line of ACFoam Products that are environmentally sensitive and available for virtually every type of construction system. Through a patented hydrocarbon blowing technology called ACUltra, Atlas began the phaseout of HCFCs in the manufacturing of foam insulation and anticipates the complete removal of HCFCs from all Atlas foam products within the next year.

Tapered ACFoam Composite/PB

Tapered ACFoam Composite/PB consists of Atlas closed-cell polyiso bonded to 1#2" perlite on the top and a fiberreinforced felt facer on the bottom. It is manufactured in a tapered profile to attain positive drainage. The perlite top eliminates the need for cover boards or vented base sheets normally recommended over foam insulations. Tapered ACFoam Composite/PB may be used with BUR, modified bitumen, and certain single-ply systems. Available in 4' x 4' (1220mm x 1220mm) only.



In 1998, years ahead of the Environmental Protection Agency timetable for eliminating HCFCs (hydrochlorofluorocarbons), Atlas introduced a line of ACFoam Products that are environmentally sensitive and available for virtually every type of construction system. Through a patented hydrocarbon blowing technology called ACUltra, Atlas began the phaseout of HCFCs in the manufacturing of foam insulation and anticipates the complete removal of HCFCs from all Atlas foam products within the next year.

Tapered ACFoam Composite/FB



Tapered ACFoam Composite/FB consists of Atlas closed-cell polyiso bonded to 1/2" high density wood fiberboard on the top and a fiber-reinforced felt facer on the bottom. It is manufactured in a tapered profile to attain positive drainage. The wood fiberboard top eliminates the need for cover boards or vented base sheets normally recommended over foam insulations. Tapered ACFoam Composite/FB may be used with BUR, modified bitumen and certain single-ply systems. Available in 4' x 4' (1220mm x 1220mm) only.

In 1998, years ahead of the Environmental Protection Agency timetable for eliminating HCFCs (hydrochlorofluorocarbons), Atlas introduced a line of ACFoam Products that are environmentally sensitive and available for virtually every type of construction system. Through a patented hydrocarbon blowing technology called ACUltra, Atlas began the phaseout of HCFCs in the manufacturing of foam insulation and anticipates the complete removal of HCFCs from all Atlas foam products within the next year.

Tapered ACFoam III

Tapered ACFoam III features ACUltra Technology which means ZERO HCFC's - a cost effective "Green" building solution. Excellent R-Values reduce energy demands while maintaining compatibility with all types of roofing membranes and fire assemblies. Tapered ACFoam III is manufactured in a tapered profile to attain positive drainage while maintaining the highest thermal efficiency available in a tapered system.

In 1998, years ahead of the Environmental Protection Agency timetable for eliminating HCFCs (hydrochlorofluorocarbons), Atlas introduced a line of ACFoam Products that are environmentally sensitive and available for virtually every type of construction system. Through a patented hydrocarbon blowing technology called ACUltra, Atlas began the phaseout of HCFCs in the manufacturing of foam insulation and anticipates the complete removal of HCFCs from all Atlas foam products within the next year.



Tapered ACFoam II



Tapered ACFoam II features ACUltra Technology which means ZERO HCFC's - a cost effective "Green" building solution. Excellent R-Values reduce energy demands while maintaining compatibility with all types of roofing membranes and fire assemblies. Tapered ACFoam II is manufactured in a tapered profile to attain positive drainage while maintaining the highest thermal efficiency available in a tapered system.

In 1998, years ahead of the Environmental Protection Agency timetable for eliminating HCFCs (hydrochlorofluorocarbons), Atlas introduced a line of ACFoam Products that are environmentally sensitive and available for virtually every type of construction system. Through a patented hydrocarbon blowing technology called ACUltra, Atlas began the phaseout of HCFCs in the manufacturing of foam insulation and anticipates the complete removal of HCFCs from all Atlas foam products within the next year.

Roof Insulation & Tapered Systems > Atlas Roofing > Polystyrene Insulation

Falcon Foam

With Falcon Foam EPS insulation, you can cost-effectively insulate any type of flat roof and be certain of quality performance. Use it on single-ply membrane roofs # loose-laid ballasted, fully-adhered or mechanically-fastened # or with a cover board and built-up roofing (BUR) systems where it makes an ideal substrate for asphalt and bitumen. The light weight of Falcon Foam tapered roof insulation makes it easy to hoist, handle and install for labor-saving economy. It can be applied in either a single or multiple layers to meet your particular requirements. And you can cut it quickly and easily with common job site tools.



Fasteners > Atlas Roofing

Atlas Roofing

Atlas Nail Base Fasteners offer specially engineered fasteners for installing Vented-R and Nail Base insulation. The use of Atlas Nail Base Fasteners, with its low profile large diameter head, eliminate the need for stress plates, thus reducing labor costs. It also requires fewer fasteners than nailing. It installs with a standard #3 square drive bit for positive driving and its sharp point speeds installation.



Fasteners > GenFlex Roofing

GenFlex Roofing

Roofing Asphalt > Owens Corning

PermaMop Modified Asphalt

In creating PermaMop® modified roofing asphalt, we didn't just one-up regular asphalts, we've three-upped them.

PermaMop is versatile. It's specially formulated for use on any slope of roof. It has the softening point of a Type IV asphalt but with a lower equiviscous temperature (EVT) than any standard Type IV. It stays where it's mopped, even on steep-sloped roofing in intense heat.

PermaMop is long lasting. In laboratory testing, ordinary asphalt exceeds 60 weather cycles (approximately 15 years). PermaMop lasts a minimum of 150% longer # withstanding up to 193 cycles. Making it an ideal choice for projects in extreme weather areas # whether it's heat, cold or moisture.



PermaMop is low fuming. Its composition includes a technologically advanced polymer additive. When heated, the polymer floats to the surface and creates a skim layer on the kettle that traps the fumes and odor inside # without affecting the asphalt or disrupting kettle operation.

Standard Type I - IV Asphalts

There's nothing ordinary about Trumbull standard built-up roofing asphalts. Like every asphalt we make, our standard Types I - IV asphalts meet or exceed ASTM standards in every category.



We exceed ASTM minimum softening points to minimize the risk of slippage and reduce "fallback." We use high flashpoint raw materials to provide added safety. We also widen the spread between equiviscous temperature (EVT) and flashpoint to support application, adhesion and waterproofing.

And to make sure our products are consistently reaching those standards, we test not once, but twice. First they're tested at our on-site plant laboratories then again at our Summit, Illinois, Technological Laboratory # one of a select few certified by the AASHTO (American Association of State Highway Testing Officials.)

TruLo Low - Fuming Asphalt

Asphalt being applied to restaurants, schools and hospitals during peak hours? With hardly any complaints?

It's true. But only when you use TruLo® Type I through IV asphalts featuring our patented low fuming technology. We've taken our already high-performing standard built-up roofing asphalts and added a technologically advanced polymer to their composition. When heated, the polymer floats to the surface and creates a skim layer on the kettle that traps the fumes and odor inside # without affecting the asphalt or disrupting kettle operation.



TruMelt Asphalt

At Trumbull, we're always thinking of new and different ways to find solutions to our customers' most pressing needs. And there's no better example than our TruMelt® asphalt. It saves time, eliminates waste and even reduces odor.

That's because with TruMelt, the product IS the packaging. Forget tearing off paper packaging or knocking off metal



bottoms, with TruMelt the entire container goes into the kettle and melts away without affecting the performance of the asphalt or the kettle. The container's rectangular shape stacks easily and weighs a mere 60 lbs. It also breaks into two 30-lb. pieces for even easier handling.

Even better, TruMelt asphalt is low fuming, featuring a technologically advanced polymer additive that creates an odor-trapping skim layer on the kettle when heated. With both no-waste and low-odor features, TruMelt is an ideal choice for jobs demanding a clean work site such as occupied buildings with limited space for trash containers.

Asphalt Adhesives

Being a shingle sealant is a demanding job. You have to bond securely, and endure scorching heat and bitter cold without slipping, cracking or separating from the shingle.

Through years of experience, research and testing, Trumbull engineers have developed three classes of shingle adhesives # each designed to bond quickly and perform like no other, even in the chilliest climates. Together they provide the performance you need, for every roof under the sun.

Standard Asphalt Sealants (Shingle Adhesive)

Stong, all-purpose sealant for warm to moderate climates.

Rubber-Modified Asphalt Sealants (T-1000)

Improved cold-weather performance that won#t become overly aggressive at high temperatures. Perfect for moderate to cold climates.

Polymer-Modified Asphalt Sealants (MSA)

Extra-tough, with low bonding temperatures. Designed for the rigorous demands of cold-weather climates.



Asphalt for Shingles

It stands to reason that an asphalt shingle is only as good as the asphalt used to make it. Which is why you should stand for nothing less than Trumbull asphalt.

Trumbull is the leading asphalt supplier for shingles. Why? Probably because asphalt is all we do. Since 1921. Over the decades we#ve gained a thorough understanding of asphalt#s properties and possibilities. In fact, we#ve applied our unmatched knowledge and expertise to create reliable, consistently high quality asphalt for use in shingle manufacturing including

Gypsum Wallboard > Georgia Pacific

DensDeck DuraGuard# Roof Board

DensDeck DuraGuard™ Roof Board is an enhanced, glass-mat roof board with a low perm, integrated coating. The durable DuraGuard™ coating provides an ideal substrate for a wide variety of adhered roofing systems, including self-adhered, hot-mopped membranes, and torched asphaltic systems. The coating assures more uniform spreading of adhesives, an excellent coverage rate, and it enhances the bond strength of membrane system-to-board without the need for field priming with a number of systems.* It is ideal for metal roof systems and fluid-applied membranes.

With patented DensDeck® design, DensDeck DuraGuard™ roof board employs glass mat facings front and back over a moisture-resistant treated gypsum core. This provides excellent fire resistance, and wind uplift properties. The glass mats also help resist jobsite damage and increase the life cycle of roof systems.

The unique construction of DensDeck DuraGuard roof board provides superior flute spanning and will help stiffen and stabilize the roof deck. It has also been shown to withstand delamination, deterioration, warping and jobsite damage more effectively than roofing membrane substrates such as paper-faced gypsum board, fiberboard and perlite insulation. DensDeck DuraGuard roof board resists the growth of mold when tested, as manufactured, per ASTM D 3273.



Oriented Strand Board

Blue Ribbon OSB is made of compressed wood strands arranged in three perpendicular layers and bonded with phenolic resin.



- # There are no core voids, knots or splits.
- # Multi-layered bonding provides exceptional dimensional stability and stiffness, and a remarkably smooth surface.
- # These panels offer strength, racking and impact resistance, uniformity and excellent fastener retention.
- # Thicknesses from 1/4" to 1 1/8" are available.

All Blue Ribbon OSB panels are APA Engineered Wood Association span-rated and Exposure 1 rated for protected construction applications that require the ability to resist moisture during construction delays. An exclusive blue edge coating helps reduce moisture absorption.

Plytanium# Thermostat# Radiant Barrier Sheathing

GP Thermostat Radiant Barrier Sheathing enhances Plytanium plywood sheathing with a highly reflective aluminum foil. Thermostat Radiant Barrier Sheathing can reduce heat flow through the ceiling up to 50 percent and save up to 20 percent on cooling energy consumption in hot, sunny climates. Best of all, it's made of Plytanium plywood, so you know it's strong and durable.

Available in 15/32" or 19/32" thick 4' x 8' panels, Plytanium Thermostat Radiant Barrier Sheathing is an outstanding product for new homes, additions or renovations. It is especially effective in hot climates or wherever you want to improve cooling energy efficiency and increase indoor comfort.

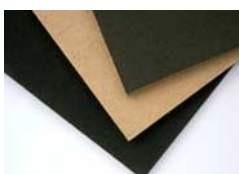
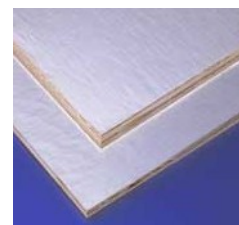

Softboard

Georgia-Pacific manufactures softboard products for traditional and manufactured home construction. Stedi-R® structural wall sheathing and high density roof fiberboard help builders and manufacturers offer environmentally and structurally sound homes, commercial buildings and offices.

Roof Pavers > Westile Roofing

Ballast Paver

The 12 lb./sq. ft. interlocking pavers provide superior resistance to wind blow off, far exceeding the performance of gravel and other paver systems. Westile Ballast Paver™ has been tested at Colorado State University to design wind speeds* of 150 mph.



Rhino# 375 - Fiberglass - Type 1AA - 375 Lbs. Rated

Louisville Ladder's top of the line fiberglass platform ladder, designed with extra heavy duty side rails and reinforcement at all critical wear points to meet the most demanding industrial applications.



Brute# 375 - Fiberglass - Type 1AA - 375 Lbs. Rated

NEW MOLDED DESIGN

Polypropylene copolymer upper boot provides strength, durability and fiberglass rail surface protection. Thick non-marring santoprene rubber tread is bonded and mechanically fastened to the upper boot and provides a slip resistance footing.

Advent# - Fiberglass - Type 1A - 300 Lbs. Rated

Extra heavy duty, 300 lb. rated industrial stepladder. Nonconductive ladder designed for everyday use by contractors and industry.





Pioneer# - Fiberglass - Type 1 - 250 Lbs. Rated

A heavy duty, 250 lb. rated stepladder for light and general industrial use. Built to last. Nonconductive fiberglass side rails with polyester veil to provide years of service without fiber prominence or blooming.

Industrial Step Stand - Fiberglass - Type 1A - 300 Lbs. Rated

These heavy duty, multi-purpose industrial step stands are available as light weight aluminum or non-conductive fiberglass. Folds for easy transport and storage.



Master# - Aluminum - Type 1A - 300 Lbs. Rated

Louisville Ladder's top-of-the-line "Master™" aluminum step ladder. Extra heavy duty, 300 lb. rated ladder with rugged extruded aluminum side rails. Designed and built to assure years of dependable, service to everyd

Rhino# 375 - Aluminum - Type 1AA - 375 Lbs. Rated

Louisville Ladder's Top-of-the-Line "Rhino 375™" aluminum step ladder. Extra heavy duty, 375 lb. rated ladder with rugged extruded aluminum side rails. Designed and built to assure years of dependable, service to everyday ladder users.





Sentry# - Aluminum - Type 1 - 250 Lbs. Rated

Heavy duty, 250 lb. rated industrial step ladder. Ideal ladder for painters and light/general industrial users.



Victor# - Aluminum - Type II - 225 Lbs. Rated

Medium duty, 225 lb. rated step ladder for general purpose and commercial applications. Superior features for a commercial grade ladder.



Artisan# Wood Step Ladder - Type 1A - 300 Lbs. Rated

Heaviest and strongest wood step ladder in our line. Extra heavy duty, 300 lb. rated pine ladder for all demanding Industrial applications. Favored by Industrial and maintenance specialists for durability.

3600 Series Wood Step Ladder - Wood - Type 1 - 250 Lbs. Rated

A heavy duty, 250 lb. rated Industrial stepladder. Ideal for light and general Industrial use. Manufactured from select ladder grade pine.



Industrial Step Stand - Aluminum - Type 1A - 300 Lbs. Rated

These heavy duty, multi-purpose Industrial step stands are available as light weight aluminum or non-conductive fiberglass. Folds for easy transport and storage.

Built Up Roofing Equipment > Louisville Ladder > Twin Front Ladder

Rhino# 375 Twin Front - Aluminum - Type 1AA - 375 Lbs. Rated

Twin-front mechanic step ladder is designed as a trestle ladder for entry from either side. Massive 375 lb. rated aluminum side rails with wide, fully serrated aluminum steps on front and back..



Master# - Aluminum - Type 1A - 300 Lbs. Rated

Twin-front mechanic step ladder is designed as a trestle ladder for entry from either side. Massive aluminum side rails with wide, fully serrated aluminum steps on front and back.

Both sides of an AM1000 series ladder can be used simultaneously by one person per side. Each side is designed to support one person including materials up to 300lbs. Total combined weight on ladder must not exceed 600lbs. (300lbs. per side).

Brute# 375 Twin - Fiberglass Step Ladder - Type 1AA - 375 Lbs. Rated

Crafted with durable parts and designed for climbing from either side. Designed to meet the most demanding Industrial/contractor applications.

Both sides of an FM1400HD series twin front step ladder can be used simultaneously by one person per side. Each side is designed to support one person including materials up to 375lbs. Total combined weight on stepladder must not exceed 750lbs. (375lbs. per side).



Advent# Twin - Fiberglass Step Ladder - Type 1A - 300 Lbs. Rated

Both sides of an FM1500 series twin front step ladder can be used simultaneously by one person per side. Each side is designed to support one person including materials up to 300lbs. Total combined weight on stepladder must not exceed 600lbs. (300lbs. per side). Same weight limit as the Type 1A Little Giant Step Ladder.

Pioneer# Twin - Fiberglass Step Ladders - Type 1 - 250 Lbs. Rated

A heavy duty, 250 lb. twin-front step ladder for light and general Industrial use. Nonconductive fiberglass side rails with wide, fully serrated aluminum steps on front and back. Designed for entry from either side.

Both sides of an FM2000 series twin front stepladder can be used simultaneously by one person per side. Each side is designed to support one person including materials up to 250lbs. Total combined weight on ladder must not exceed 500lbs. (250lbs. per side). This is the same weight limit as the Type 1 Little Giant Step Ladder.



Advent Platform Ladder - Fiberglass - Type 1AA - 300

Extra heavy duty, 300 lb. rated platform ladder. Nonconductive fiberglass heavy duty side rails and reinforcement at all critical wear points to meet the most demanding industrial / contractor applications.



Brute 375# Platform Ladder - Fiberglass - Type 1AA - 375 Lbs. Rated

Our NEW fiberglass platform ladder designed for prolonged standing at one height. Nonconductive fiberglass rails with fully serrated aluminum steps and platform. Size measured to platform.

Polypropylene copolymer upper boot provides strength, durability and fiberglass rail surface protection. Thick non-marring Santoprene® rubber tread is bonded and mechanically fastened to the upper boot and provides a slip resistant footing.

Master# Platform Ladder - Aluminum - Type 1A - 300 Lbs. Rated

Extra heavy duty platform ladder designed for prolonged standing at one height. Aluminum side rails with fully serrated aluminum steps and platform. Size measured to platform.





Stockmaster# Mobile Platform Ladder - Aluminum - Type 1A - 300 Lbs. Rated

Innovative engineering enhances the valuable features of the AP5000 Stockmaster™ Platform Step Ladder. More mobile and easy to use. Designed for stocking and material handling applications.

Rhino 375# Platform Ladder - Aluminum - Type 1AA - 375 Lbs. Rated

Louisville's NEW Top-of-the-Line aluminum platform ladder, designed with extra heavy duty side rails and reinforcement at all critical wear points to meet the most demanding Industrial / contractor applications.



Built Up Roofing Equipment > Louisville Ladder > Extension Ladders

Kentuckian# Wood Extension - Type 1A - 300 Lbs. Rated

Extra heavy duty Industrial extension. Partially rodded, parallel sides are standard. Designed for a 300 lb. workload when set at the proper working angle.





Rhino# 375 Extension - Aluminum - Type 1AA - 375 Lbs. Rated

Our top-of-the-line aluminum extension ladder. Extra heavy duty I-beam construction for demanding Industrial applications. Designed for a 375 lb. workload when set at the proper working angle.

Admiral# Stacked Extension - Aluminum - Type 1A - 300 Lbs. Rated

This extra heavy duty extension ladder does double duty; together it can be used as an extension ladder or separated it becomes two single ladders. Meets ANSI codes for use as a straight ladder.



Louisville Colonel# Extension - Aluminum - Type 1A - 300 Lbs. Rated

Our most popular aluminum extension ladder for contractors and industry. Extra heavy duty I-beam side rails. Designed for a 300 lb. workload when set at the proper working angle.

Commander# Extension - Aluminum - Type 1 - 250 Lbs. Rated

Heavy duty Industrial extension yet light in weight. Built with top quality features for economical service. Designed for a 250 lb. workload when set at the proper working angle.





Industrial 3-Section Extension - Aluminum - Type 1 - 250 Lbs. Rated
Industrial Grade 3-Section Extension extends to a maximum length of 48 ft.

Commercial# Extension - Aluminum - Type II - 225 Lbs. Rated

commercial grade extension ladder for general purpose and light Industrial use. Designed for a 225 lb. workload when set at the proper working angle.



Household Extension - Aluminum - Type III - 200 Lbs. Rated

Household grade extension ladder for light general purpose use. Designed for a 200 lb. workload when set at the proper working angle.

ManHole Ladder - Fiberglass - Type 1A - 300 Lbs. Rated

A narrow fiberglass straight ladder especially designed for use in manholes. All sizes are 14" wide. Nonconductive full channel fiberglass side rails.





Rung to Plate Connect - Fiberglass - Type 1A - 300 Lbs. Rated

Features

- Aluminum Plate Connection Rungs - Tempered aluminum rungs are hydraulically double crimped to aluminum plate. Each plate is fastened to side rails with four solid aluminum rivets.
- D-Shaped or Round Rungs - Tempered, serrated aluminum rungs provide for a slip-resistant surface.
- Mar-Resistant Rail End Caps - Impact resistant caps on all rail ends provide rail protection for longer life and protect work surfaces from marring.
- Louisville Ladder's Full Metal Boot™ - Extra heavy duty cast aluminum shoes with thick rubber tread. Exclusive Louisville Ladder design. Full swivel safety shoe can be used with tread down or in spike position.
- QuickLatch™- QuickLatch™ equipped runglock provides easier method of securing fly and base sections when extended. One-finger operation. Patent #5429207

Type 1A Channel - Fiberglass - Type 1A - 300 Lbs. Rated

The extra heavy duty, channel extension ladder for lighter Industrial use. Full channel nonconductive side rails. Designed for 300 lb. workload when set at the proper working angle.



Type 1 Channel - Fiberglass - Type 1 - 250 Lbs. Rated

A heavy duty extension ladder designed for a 250 lb. workload when set at the proper working angle. The ideal non-conductive ladder for painters, electricians and general Industrial use. Full channel fiberglass side rails.

Type II Channel - Fiberglass - Type II - 225 Lbs. Rated

A heavy duty extension ladder designed for a 225 lb. workload when set at the proper working angle. The ideal non-conductive ladder for painters, electricians and general Industrial use. Full channel fiberglass side rails.





Rhino# 375 - Fiberglass - Type 1AA - 375 Lbs. Rated

Louisville's Top of the Line Fiberglass Extension Ladder - designed to meet the most demanding utility, Industrial, and contractor applications.

Built Up Roofing Equipment > Cleasby Roofing > Lo - Loader Kettles

Model 30 Gal. Skid Mounted Patch Kettle

Popular stationary model patch kettle. Ideal for small patch jobs, shower pans and high rise buildings. Allows the roofer to have dispense hot asphalt in those hard to reach areas. Includes L.P. vapor burner, 10# L.P. hose, thermometer and regulator. Available insulated or non-insulated. Insulated kettles melt approximately 30% more #HOT# than non-insulated.



Model 30 Gal. Portable Patch Kettle

Portable patch kettle offers all the same desirable features of the skid mounted model with the added convenience of being wheeled. Easy to maneuvering in tight areas. Equipped with L.P. vapor burner, 10# L.P. hose, thermometer and regulator. Available insulated or non-insulated. Insulated kettles melt approximately 30% more #HOT# than non-insulated.

Model 115 Gal. Skid Mounted Patch Kettle

Where fire codes permit, this small patch kettle can be easily disassembled and used on the roof top. Fits on commercial elevators and through most doors. Tube fired single burner. Available with or without automatic controls.



Model 115 Gal. Towable Patch Kettle

Offers all the convenient features of the 115 skid mounted model with the added advantage of being towable. Ideal for shower pans, patch work, small add-ons, yet big enough for residential construction. Tube fired with a single burner. Available with or without automatic controls.

Model 200 Gal. Single Burner Pumper Kettle

A lot of kettle for the dollar. A single axle portable kettle equipped with a 35 g.p.m. pump, 8 h.p. engine, tail lights and a removable adjustable hitch. It has a tube fired single manual burner. Automatic controls are optional.



Model 260 Gal. Single Burner Kettle

The right kettle for a small job. This single axle kettle has as an optional heavy duty 60 g.p.m. pump system for faster asphalt delivery to the roof. Standard equipment includes 35 g.p.m pump system, tail lights, and a removable, adjustable hitch. Manual or automatic L.P. vapor controls available.

Model 350 Gal. Double Burner Pumper Kettle

A highly desirable model for easy maneuverability and large enough for higher volume work. Double burners are used for faster heating and fuel efficiency. Standard features include, 35 g.p.m. pump, removable, adjustable hitch, and tail lights. Manual or automatic l.p.g. vapor controls available. Recommended options include 60 G.P.M. pump and electric brakes.

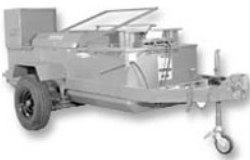

Model 425 Gal. Double Burner Pumper Kettle

The largest of our single axle models. Offers the same wheel base and loading height as our 350 gal. kettle while allowing for 65 gallons more usable asphalt. Same standard features including double burners, 35 g.p.m. pump, removable adjustable hitch and tail lights. Manual or automatic l.p.g. vapor controls offered. Manufacturers suggested options are a 60 g.p.m. pump and electric brakes.

Model 540 Gal. Double Burner Pumper Kettle

The favorite of our kettles. Suitable for most large commercial jobs and small residential work alike. Dual axles maximize the kettles road stability. Double burners, removable adjustable hitch, tail lights, electric brakes one axle and 35 g.p.m. pump are standard features. Manual or automatic l.p.g. vapor controls available. Manufacturer recommends 60 G.P.M. pump system.



Model 695 Gal. Double Burner Pumper Kettle

A large capacity kettle built with the same low loading height as our 540 gal. model yet gives the roofer 130 gals. of additional usable asphalt. Standard features include double burners, 35 g.p.m. pump, tail lights, removable adjustable hitch and electric brakes one axle. Select manual or automatic controls. Manufacturers recommended option is a 60 g.p.m. pump system.

Model 845 Gal. Quad Burner Pumper Kettle

Equipped with Cleasby's exclusive double barrel spiral flame burners which in effect gives you two burners in each 10# heat tube. This exclusive design generates 2 million B.T.U.'s per hour. The highest in the industry. 60 G.P.M. heavy duty pump system, tail lights, removable adjustable hitch and electric brakes are standard. Select manual or automatic controls.





Model 1200 Gal. Quad Burner Pumper Kettle

A big kettle for the big job, the highest production kettle manufactured in the U.S. Both the 845 and 1200 gal. kettles have our exclusive double barrel burners that produce 2 million B.T.U.#s per hour. 60 g.p.m. heavy duty pump system, tail lights, removable adjustable hitch and electric brakes on all three axles are standard equipment. Manual or automatic controls available.

Built Up Roofing Equipment > Cleasby Roofing > Oil Jacketed Kettles

200 Gal. Oil Jacketed Kettle

Our 200 gal. model is uniquely built with four heating tubes submerged in a heat transfer oil chamber. Rubberized asphalt heats and maintains heat longer than any other rubberized asphalt kettle on the market.

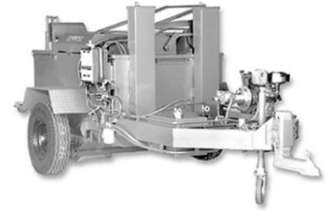

Built Up Roofing Equipment > Cleasby Roofing > Kettle Pumps

Gear Box and Gear Box Mount

Right angle drive gear box

Right angle drive gear box mount

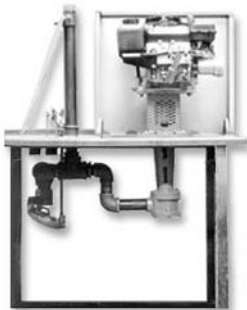

Standard 35 G.P.M.Pump System Complete

Parts Include:

1. 8 h.p. engine
2. Pump and syphon screen
3. Hot valve and valve guard
4. Engine cover (not shown)
5. L.P.G. engine conversion (optional)

H.D. 60 G.P.M. Pump System Complete

Parts Include:

1. 8 h.p. engine, (10 h.p. engine optional)
2. Pump and syphon pickup
3. Hot valve and valve guard
4. Engine cover (not shown)
5. L.P.G. engine conversion (optional)

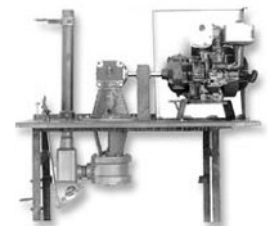



Hot Valve with Surge Chamber

Built in surge chamber greatly reduces back pressure significantly extending the life of the engine and pump.

Model 35 G.P.M. Pump

Standard 35 G.P.M. positive displacement rotary gear pump. Pump bracket extends pump head down into the hot asphalt for quicker start-up time. Weight 35 lbs.



Model 35 G.P.M. Pump

Standard 35 G.P.M. positive displacement rotary gear pump. Pump bracket extends pump head down into the hot asphalt for quicker start-up time. Weight 35 lbs.

Mold 60 G.P.M. Pump

Heavy duty 60 G.P.M. positive displacement rotary gear pump. Pump bracket extends pump head down into hot asphalt for quicker start-up time. Weight 85 lbs.



Flex Coupling with Bronze Spider

1# x 1# Flex coupling # engine to right angle drive

Bronze spider for flex coupling

Built Up Roofing Equipment > Cleasby Roofing > Kettle Accessories

Thin Wall Tubing

Cleasby's heavy duty 13 gauge thin wall tubing is the sturdiest in the industry. Made from 1 1/2# steel tubing with a welded on coupling and tie-back eye. Available in four different lengths with stockham (standard) or hammer-on unions.





Pipe Bends

Cleasby's heavy duty 13 gauge thin wall tubing is the sturdiest in the industry. Made from 1 1/2# steel tubing with a welded on coupling and tie-back eye. Available in four different lengths with stockham (standard) or hammer-on unions.

Swivel Pipe Set-ups w/ Unions

Cleasby's heavy duty 13 gauge thin wall tubing is the sturdiest in the industry. Made from 1 1/2# steel tubing with a welded on coupling and tie-back eye. Available in four different lengths with stockham (standard) or hammer-on unions.



Hot Pipe Insulation

Hot pipe insulation (75# per box)

Hot pipe insulation (3# section)

Propane Hoses

Rubber covered U.L. approved hose in 3/8# and 1/2# I.D. Use 3/8# for all applications through 425 gal. kettles. For 540 gal. through 1200 gal. kettles, use 1/2# hose.

Metal Flex Hoses

1/2# metal flex hose with fitting on one end. Standard hose sizes are 3# and 5#. Special sizes cut to order. Available with Stockham (standard), Hammer-on unions, or Tri-lug unions.

Rubber Flex Hoses

1 1/2# diameter with fitting on one end Stockham (standard), Hammer-on , or Tri-lug union optional.

Propane Bottle Hook Ups

Propane Bottle Hook Ups

Inspector's Thermometer

Popular asphalt inspector's thermometers for taking asphalt temperature readings at the point of application.

Kettle Skimmer

Kettle Skimmer

Mops & Hand Tools

Mops & Hand Tools



Skylights & Roof Hatches > American Skylites

American Skylites

Skylights & Roof Hatches > Bilco > Roof Scuttles

Type S Roof Scuttle

Type S, 36" x 30" (914mm x 762mm), the easy one-hand operation to the fully open or close position provides the ladder user the security of having one hand firmly on the ladder at all times. Available in galvanized steel or aluminum construction.



Type GS Roof Scuttle

Type GS, 36" x 30" (914mm x 762mm), all the security and convenience of the Type S scuttle with the added benefits of a skylight. Features polycarbonate dome cover, aluminum construction, and easy one-hand operation.

Type E Roof Scuttle

Type E, 36" x 36" (914mm x 914mm), ideal for applications requiring roof access slightly larger than the typical 36" x 30" opening. They are commonly used to remove or install small pieces of equipment in a building.



Skylights & Roof Hatches > Milcor

Milcor

Reglet > Fry Reglet

Fry Reglet